

ACBMV B. CASADIO VIBRATION
 Z.I. Mi-Plaine
 51 Rue Ampère
 B.P. 31
 69682 CHASSIEU CEDEX (FRANCE)
 Tel.: 04 78 90 87 87 / Fax.: 04 78 90 87 88
 Email: vibrateur@orange.fr
 Internet: acbm.com

4 POLES - 1500 RPM
 REF.: 601350A
 SIZE: 50

Certifications:



MECHANICAL AND ELECTRICAL SPECIFICATIONS

| Eccentric weight setup (%) | Static moment (kgmm) | Working moment (kgcm) | Centrifugal force (kg) | Centrifugal force (kN) | Estimated bearings life time (hours) |
|----------------------------|----------------------|-----------------------|------------------------|------------------------|--------------------------------------|
| 100 | 715 | 143,00 | 1798 | 17,60 | 35540 |
| 90 | 643,50 | 128,70 | 1618 | 15,84 | 50515 |
| 80 | 572,00 | 114,40 | 1438 | 14,08 | 74843 |
| 70 | 500,50 | 100,10 | 1259 | 12,32 | >100000 |
| 60 | 429,00 | 85,80 | 1079 | 10,56 | >100000 |
| 50 | 357,50 | 71,50 | 899 | 8,80 | >100000 |
| 40 | 286,00 | 57,20 | 719 | 7,04 | >100000 |
| 30 | 214,50 | 42,90 | 539 | 5,28 | >100000 |
| 20 | 143,00 | 28,60 | 360 | 3,52 | >100000 |
| 10 | 71,50 | 14,30 | 180 | 1,76 | >100000 |

| | |
|------------------------|--------------|
| Power supply (volts) | 400 |
| Phases: | three phases |
| Frequency (Hz) | 50 Hz |
| Rotation speed (RPM) | 1500 |
| Max input power (watt) | 1100 |
| Max current (amp) | 2 |
| IS/IR | 4,89 |

DIMENSIONAL SPECIFICATIONS (mm)

Vibrator weight: 58,5 kg

Continual service ambient temperature: -20°C à +40°C - Tropicalization anti-mold - Mechanical protection: IP66 IK08 according to IEC

Bearing type: ROLLER

Lubrication LONG-LIFE with KLUEBER STABURAGS NBU 8EP.

Re lubrication quantity after 1000 hours of using: 16g

Max quantity by replaced bearing: 30g

Fixing with 4 screws M16 - 5/8" quality 8.8 with tightening torque (kgm - ft/lb): 19 - 137

Power supply cable size: 9 à 16 mm - Cable entry thread: M25x1,5

Maintenance space: 129 mm

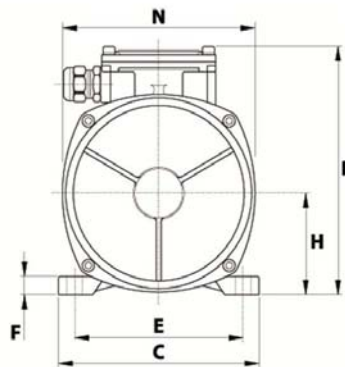
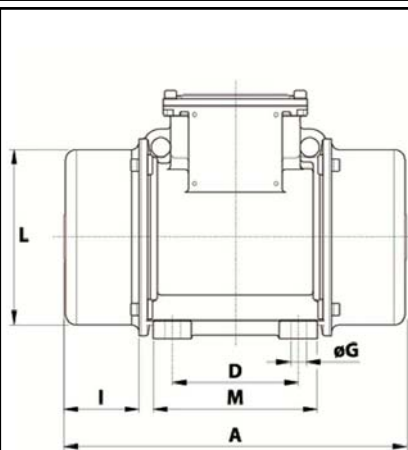

| | |
|----------|------|
| A | 490 |
| B | 245 |
| C | 230 |
| D | 140 |
| E | 190 |
| F | 25 |
| G | 17 |
| N° HOLES | 4 |
| H | 116 |
| I | 129 |
| L | 201 |
| M | 180 |
| N | 225- |

| | | | | | |
|--|--|--|--|--|--|
| | | | | | |
| | | | | | |